



VersiJet™ Series

HIGH CAPACITY PUMPS

The New VersiJet High Capacity Pumps are backed by Flojet's diaphragm pump technology, a brand enjoying over 35 years of operational excellence. The innovative new and improved five chamber design offers unequalled performance, capable of handling up to 6 GPM at open flow.

With pressures up to 70 psi (4.8 bar), self-priming capabilities up to 10 feet (wetted), and heavier duty brushes extending the operating life up to 50% longer than existing Flojet Quad Series diaphragm pumps, the Flojet VersiJet pumps are designed to be the most reliable and versatile pumps on the market today. These pumps are the ideal solution for applications including spraying, fluid transfer, filtration, cooling, dispensing and pressure boosting.

The Flojet VersiJet Series High Capacity Pumps are made from Santoprene®/EPDM and Santoprene®/Viton®, resulting in true compatibility with most harsh and abrasive chemicals.

Features and Benefits

- Multiple sizing options, providing flow up to 6 GPM (22.7 LPM) and pressure up to 70 psi (4.8 bar)
- Robust material selection, suitable for handling a broad range of chemicals
- Co-injected molded diaphragm technology, ensuring run dry capability, extending the life of the pump upwards of 50%
- IPX6 rated pump with a sealed motor and pressure switch, providing years of dependable reliability
- Self priming, accommodating up to 10ft (3m) (wetted)



FLOJET
a xylem brand

Applications



- **General Industrial**
 - Chemical Washdown
 - Evaporative Cooling Systems
 - Fluid Transfer



- **Agricultural**
 - Fogging / Misting
 - Boom Sprayers (to reach tree tops)



- **Automotive**
 - DEF (Diesel Exhaust Fluid) Transfer
 - Fluid Exchange Exhaust Cleaning

Head-Flow Chart

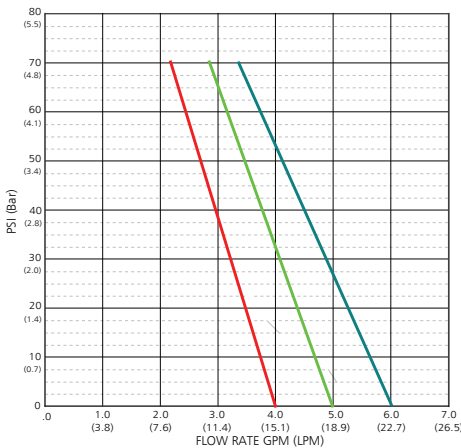

| 4.0 GPM | | | |
|---------|-----|------|--|
| PSI | GPM | AMPS | |
| 0 | 4.0 | 3.6 | |
| 10 | 3.8 | 5.0 | |
| 20 | 3.5 | 6.4 | |
| 30 | 3.3 | 7.8 | |
| 40 | 3.0 | 9.0 | |
| 50 | 2.7 | 10.1 | |
| 60 | 2.5 | 11.1 | |
| 70 | 2.2 | 12.0 | |

| 5.0 GPM | | | |
|---------|-----|------|--|
| PSI | GPM | AMPS | |
| 0 | 5.0 | 5.5 | |
| 10 | 4.7 | 7.9 | |
| 20 | 4.4 | 9.5 | |
| 30 | 4.1 | 10.9 | |
| 40 | 3.8 | 12.1 | |
| 50 | 3.4 | 13.1 | |
| 60 | 3.1 | 14.0 | |
| 70 | 2.8 | 14.7 | |

| 6.0 GPM | | | |
|---------|-----|------|--|
| PSI | GPM | AMPS | |
| 0 | 6.0 | 7.4 | |
| 10 | 5.7 | 8.3 | |
| 20 | 5.3 | 10.1 | |
| 30 | 4.9 | 11.6 | |
| 40 | 4.5 | 13.0 | |
| 50 | 4.1 | 14.4 | |
| 60 | 3.7 | 15.2 | |
| 70 | 3.3 | 15.6 | |

| 15.1 LPM | | | |
|----------|------|------|--|
| PSI | GPM | AMPS | |
| 0 | 15.1 | 3.6 | |
| 0.7 | 14.2 | 5.0 | |
| 1.4 | 13.3 | 6.5 | |
| 2.0 | 12.3 | 7.8 | |
| 2.8 | 11.3 | 9.0 | |
| 3.4 | 10.3 | 10.1 | |
| 4.1 | 9.3 | 11.1 | |
| 4.8 | 8.3 | 12.0 | |

| 18.9 LPM | | | |
|----------|------|------|--|
| PSI | GPM | AMPS | |
| 0 | 18.9 | 5.5 | |
| 0.7 | 18.1 | 7.9 | |
| 1.4 | 16.8 | 9.5 | |
| 2.0 | 15.5 | 10.9 | |
| 2.8 | 14.2 | 12.1 | |
| 3.4 | 13.0 | 13.1 | |
| 4.1 | 11.9 | 14.0 | |
| 4.8 | 10.6 | 14.7 | |

| 22.7 LPM | | | |
|----------|------|------|--|
| PSI | GPM | AMPS | |
| 0 | 22.7 | 7.4 | |
| 0.7 | 21.4 | 8.3 | |
| 1.4 | 20.0 | 10.1 | |
| 2.0 | 18.5 | 11.6 | |
| 2.8 | 17.0 | 13.0 | |
| 3.4 | 15.5 | 14.4 | |
| 4.1 | 14.0 | 15.2 | |
| 4.8 | 12.5 | 15.6 | |

Note: Pressure, flow and Amp data is tested at 12.8 volts.
See Flojet R7300 series for 7.0 GPM models.

Specifications

| | |
|---------------------------------|--|
| Motor Design | Perm. Magnet TENV (non-ventilated) |
| Voltage Options | 12 VDC, 24 VDC, 115 VAC, 230 VAC |
| Pump Head Material | Glass Filled Nylon |
| Diaphragm Elastomer | Santoprene® |
| Check Valve Materials | Glass Filled Nylon, EPDM or Viton® |
| Maximum Flow Rate | 6.0 GPM (22.7 LPM) |
| Maximum Pressure | 70 psi (4.8 bar) |
| Duty Cycle | Intermittent |
| Weight | 7.6lbs (3.5kg) |
| Certifications | CE, RoHs, IPX6 |
| Standard Port Size Inlet/Outlet | 1/2" HB (4 GPM), 3/4" HB (5 and 6 GPM) |

Dimensional Drawing - 5 GPM / 6 GPM models

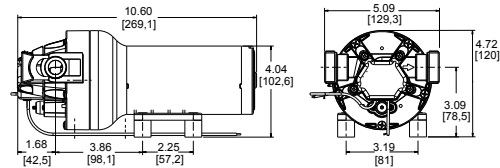

Note: 4 GPM model overall length 9.91in (251.7mm). All other dimensions are the same as the 5 GPM / 6 GPM models. Dimensions in inches [mm]

| Part No. | Volts | GPM (LPM) | Switch PSI (Bar) | Diaphragm | Check Valve |
|----------|-------|-----------|------------------|-----------|-------------|
| R8400144 | 12 | 4 (15.1) | 70 (4.8) | Santo | EPDM |
| R8400344 | 24 | 4 (15.1) | 70 (4.8) | Santo | EPDM |
| R8400044 | 115 | 4 (15.1) | 70 (4.8) | Santo | EPDM |
| R8400244 | 230 | 4 (15.1) | 70 (4.8) | Santo | EPDM |
| R8400134 | 12 | 4 (15.1) | 70 (4.8) | Santo | Viton |
| R8400334 | 24 | 4 (15.1) | 70 (4.8) | Santo | Viton |
| R8400034 | 115 | 4 (15.1) | 70 (4.8) | Santo | Viton |
| R8400234 | 230 | 4 (15.1) | 70 (4.8) | Santo | Viton |

| Part No. | Volts | GPM (LPM) | Switch PSI (Bar) | Diaphragm | Check Valve |
|----------|-------|-----------|------------------|-----------|-------------|
| R8500144 | 12 | 5 (18.9) | 70 (4.8) | Santo | EPDM |
| R8500344 | 24 | 5 (18.9) | 70 (4.8) | Santo | EPDM |
| R8500044 | 115 | 5 (18.9) | 70 (4.8) | Santo | EPDM |
| R8500244 | 230 | 5 (18.9) | 70 (4.8) | Santo | EPDM |
| R8500134 | 12 | 5 (18.9) | 70 (4.8) | Santo | Viton |
| R8500334 | 24 | 5 (18.9) | 70 (4.8) | Santo | Viton |
| R8500034 | 115 | 5 (18.9) | 70 (4.8) | Santo | Viton |
| R8500234 | 230 | 5 (18.9) | 70 (4.8) | Santo | Viton |

| Part No. | Volts | GPM (LPM) | Switch PSI (Bar) | Diaphragm | Check Valve |
|----------|-------|-----------|------------------|-----------|-------------|
| R8600144 | 12 | 6 (22.7) | 70 (4.8) | Santo | EPDM |
| R8600344 | 24 | 6 (22.7) | 70 (4.8) | Santo | EPDM |
| R8600044 | 115 | 6 (22.7) | 70 (4.8) | Santo | EPDM |
| R8600244 | 230 | 6 (22.7) | 70 (4.8) | Santo | EPDM |
| R8600134 | 12 | 6 (22.7) | 70 (4.8) | Santo | Viton |
| R8600334 | 24 | 6 (22.7) | 70 (4.8) | Santo | Viton |
| R8600034 | 115 | 6 (22.7) | 70 (4.8) | Santo | Viton |
| R8600234 | 230 | 6 (22.7) | 70 (4.8) | Santo | Viton |

Santoprene® is a registered trademark of Monsanto.

Viton® is registered trademark of DuPont Performance Elastomers.



Warranty: All products of the company are sold and all services of the company are offered subject to the company's warranty and terms and conditions of sale, copies of which will be furnished upon request. The information provided herein is for guidance only, it does not constitute a guarantee of the performance or specification of any individual product or component.

www.xyleminc.com

USA
Xylem Inc.
100 Cummings Center Drive
Suite 535-N, Beverly, MA 01915
Tel: +1 978 281-0440
Fax: +1 978 283-2619

UK
Xylem Inc.
Bingley Road, Hoddesdon
Hertfordshire EN11 0BU
Tel: +44 (0) 1992 450145
Fax: +44 (0) 1992 467132

GERMANY
Xylem Inc.
Oststrasse 28
22844 Norderstedt
Tel: +49-40-53 53 73-0
Fax: +49-40-53 53 73-11

CHINA
Xylem Inc.
30/F, Tower A Hongqiao City
Center of Shanghai 100 Zunyi
Road, Shanghai 200051, China
Tel: +(86) 21 2208 2888
Fax: +(86) 21 2208 2999

ITALY
Xylem Inc.
Via Tommaseo, 6
20059 Vimercate, Milano
Tel: +39 039 685 2323
Fax: +39 039 666 307